

# OVERHEAD MAINTENANCE 0700 TO 1700

NOTE: TRAFFIC CONTROLLERS ARE TO ASSIST PEDESTRIANS SAFELY PAST THE WORKSITE

NOTE: DUE TO THE LIMITED ROAD WIDTH, GATING CONES ARE NOT TO BE PLACED ON THE CENTRE OF THE ROAD UNLESS INDICATED. SEE TMP SECTION 3.2.

PRIORITY IS TO BE GIVEN TO WESTBOUND VEHICLES TURNING FROM TROSSELL ST

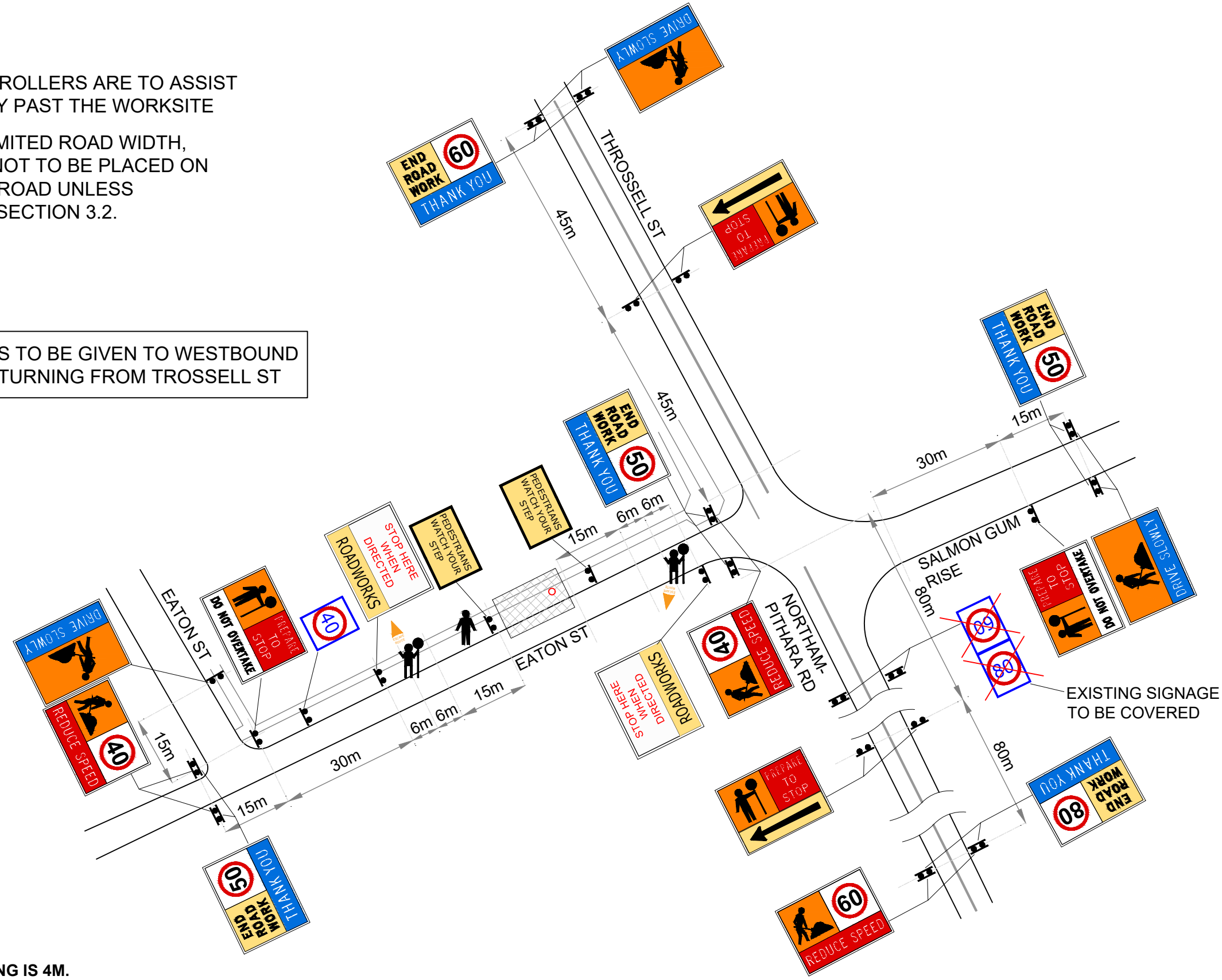

## SPEED REDUCTION REVERSIBLE FLOW

### LEGEND

- WORKSITE
- POLE
- TRAFFIC CONE (4m)

### SIGNAGE MANIFEST

	X 2
	X 4
	X 2
	X 2
	X 4
	X 5
	X 1
	X 2
	X 2
	X 2
	X 1
	X 13

### NOTES

- TRAFFIC CONE SPACING IS 4M.
- ALL PLANS TO BE READ IN CONJUNCTION WITH THE TRAFFIC MANAGEMENT DOCUMENT
- WHERE SPEED SIGNS ARE INCORPORATED IN MULTI-MESSAGE SIGNS THAT ARE DUPLICATED THE SPEED SIGN WILL ALWAYS BE LOCATED NEAREST TO THE TRAFFIC
- THE LOCATION OF SIGNS AS SHOWN ON THIS PLAN MAY BE VARIED SLIGHTLY DURING IMPLEMENTATION TO IMPROVE VISIBILITY AND EFFECTIVENESS AS PER THE AGTMM PT 6. ANY CHANGES TO BE DOCUMENTED
- ALL REDUNDANT SPEED SIGNS TO BE COVERED
- AFTER INSTALLATION A DRIVE - THROUGH INSPECTION IS TO BE CONDUCTED AND SIGNS ADJUSTED FOR MAXIMUM EFFECTIVENESS

<p><b>LGC</b> TRAFFIC MANAGEMENT LGC TRAFFIC HEAD OFFICE 6 BUSHBY ST, BELLEVUE WESTERN AUSTRALIA 6056 (08) 9374 0161 CONTACT@LGCTRAFFIC.COM.AU</p>	<p><b>GENUS</b> GENUS INFRASTRUCTURE 11-15 COOPER AVE KENWICK WA 6107 9390 6999</p>	REV #	DATE	COMMENTS	NAME	ACCREDITATION	SIGNATURE	DATE DRAFTED:	SCALE:	DRAWING NO:		
		0	16/01/2024	ORIGINAL VERSION	DESIGNED BY:	DARREN HOUGH	AWTM 22-05201-03		16/01/2024	NOT TO SCALE	LGCP-5958-002	
		01	25/01/2024	REVISED VERSION	DRAFTED BY:	DARREN HOUGH	AWTM 22-05201-03		POSTED SPEED:	50/60 KM/H	LOCATION:	EATON ST GOOMALLING
					REVIEWED BY:	CLANSY HOLT	AWTM 21-3216-05		WORKSITE SPEED:	40 KM/H	ROAD AUTHORITY:	MRWA & SHIRE OF GOOMALLING
										REVISION:	REV 01	
										LGCTE0020 (TGS)	ISSUE: 12/10/23 REV 2	
										FOR THE MOST CURRENT VERSION OF THIS CONTROLLED DOCUMENT, REFER TO THE LGC DATA SERVER		